

BRIDE PLEINE

Type 5A

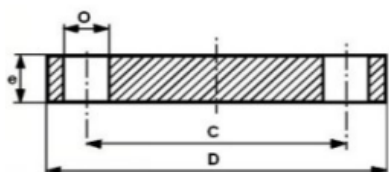

| | DN | D | e | N | O | C | Kg |
|------------|-----|-----|----|----|----|-----|-------|
| PN10/16/40 | 15 | 95 | 14 | 4 | 14 | 65 | 0.71 |
| | 20 | 105 | 16 | 4 | 14 | 75 | 1.02 |
| | 25 | 115 | 16 | 4 | 14 | 85 | 1.22 |
| | 32 | 140 | 18 | 4 | 18 | 100 | 1.80 |
| | 40 | 150 | 18 | 4 | 18 | 110 | 2.10 |
| PN10/PN16 | 50 | 165 | 18 | 4 | 18 | 125 | 2.85 |
| | 65 | 185 | 18 | 8 | 18 | 145 | 3.65 |
| | 80 | 200 | 20 | 8 | 18 | 160 | 5.05 |
| | 100 | 220 | 20 | 8 | 18 | 180 | 6.20 |
| | 125 | 250 | 22 | 8 | 18 | 210 | 8.85 |
| | 150 | 285 | 22 | 8 | 22 | 240 | 11.40 |
| PN10 | 200 | 340 | 24 | 8 | 22 | 295 | 17.90 |
| | 250 | 395 | 26 | 12 | 22 | 350 | 26.00 |
| | 300 | 445 | 26 | 12 | 22 | 400 | 33.00 |
| PN16 | 200 | 340 | 24 | 12 | 22 | 295 | 17.60 |
| | 250 | 405 | 26 | 12 | 26 | 355 | 31.00 |
| | 300 | 460 | 28 | 12 | 26 | 410 | 40.00 |
| PN40 | 50 | 165 | 20 | 4 | 18 | 165 | 3.10 |
| | 65 | 185 | 22 | 8 | 18 | 185 | 4.00 |
| | 80 | 200 | 24 | 8 | 18 | 200 | 5.50 |
| | 100 | 220 | 24 | 8 | 22 | 235 | 7.00 |

DEMANDEZ VOTRE DEVIS

Sur notre site internet
www.atlantic-robinetterie.fr

Par mail : atlantic.rob@groupe-sofia.fr

Par téléphone : 02 40 00 04 75

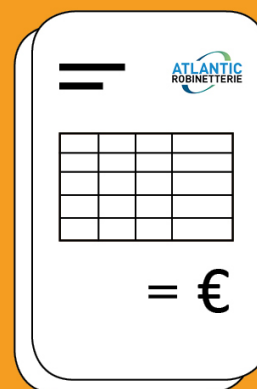

RÉPONSE RAPIDE

ATLANTIC ROBINETTERIE
SPÉCIALISTE DE LA FOURNITURE INDUSTRIELLE
44600 - SAINT NAZAIRE

